

OFFICE CUBICLE TOPPER™

MEASUREMENT GUIDE



Getting the cubicle topper you need couldn't be easier. Below is a simple description on what you need and how to measure your existing cubicles to be fit for the topper. Please contact your local SMG Sales person with any questions about this product.

YOU WILL NEED

An ordinary tape measure and pencil and paper to write down the measurements. It may be more efficient to have a helper to write down the dimensions as they're being measured. Also consider working from a plan if available to keep organized.



1 Measure the top rail

Get an accurate measurement of the top rail width. This will determine how the support legs will be cut to ensure a snug fit. Not all top rail widths are the same so a thorough inspection may be needed.

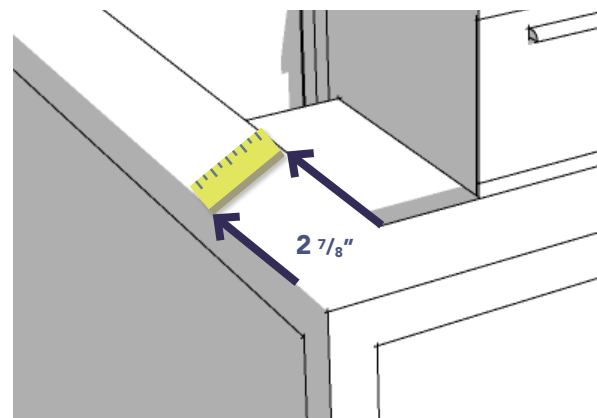

2 Measure each section

Measure the length of each section of the cubicle where a topper is needed. Keep an organized record for all measurements. It is recommended to work off an accurate floor plan but a simple sketch can also be used. Labeling each section as in the example shown is also helpful.

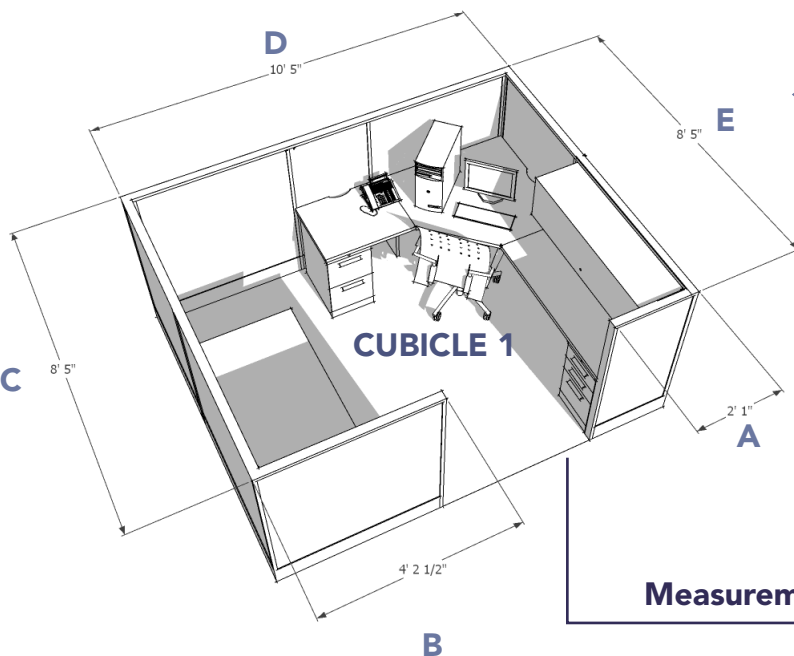

Measurement Chart Example

CUBICLE 1	
Section	Length
A	2'-1"
B	4'-2.5"
C	8'-5"
D	10'-5"
E	8'-5"